

## BOCHTEN SMARTLINE MANCHET/SPIE GEBROKEN WIT

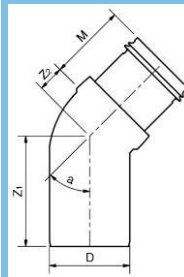

Artikelnr.	Diam. (D)	$\alpha$	M	Z <sub>2</sub>	Z <sub>1</sub>
HS178001	40	15°	39	12	49
HS178021	40	45°	39	13	55
HS178041	40	88°	39	24	67
HS178002	50	15°	41	14	51
HS178022	50	45°	41	16	60
HS178042	50	88°	41	30	77

## BOCHTEN SMARTLINE MANCHET/SPIE CHROOM

Artikelnr.	Diam. (D)	$\alpha$	M	Z <sub>2</sub>	Z <sub>1</sub>
HS178201	40	15°	39	12	49
HS178221	40	45°	39	13	55
HS178241	40	88°	39	24	67

## BOCHTEN SMARTLINE GEBROKEN WIT

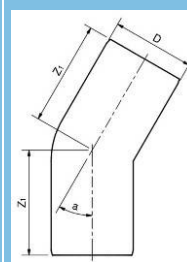

Artikelnr.	Diam. (D)	$\alpha$	Z <sub>2</sub>	Z <sub>1</sub>
HS178011	40	30°	51	51
HS178031	40	67°	59	51
HS178012	50	30°	55	55
HS178032	50	67°	65	65

## BOCHTEN SMARTLINE CHROOM

Artikelnr.	Diam. (D)	$\alpha$	Z <sub>2</sub>	Z <sub>1</sub>
HS178211	40	30°	51	51
HS178231	40	67°	59	51

## BUIZEN SMARTLINE GEBROKEN WIT

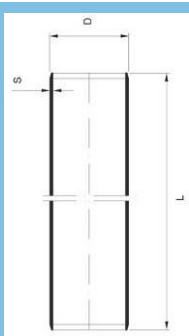

Artikelnr.	Diam. (D)	L	S
BS080125	40	1000	1,8
BS080127	40	3000	1,8
BS080135	50	1000	1,8
BS080136	50	3000	1,8

## BUIS SMARTLINE CHROOM

Artikelnr.	Diam. (D)	L	s
BS080130	40	1000	1,8

## KOPPELSTUKKEN SMARTLINE GEBROKEN WIT

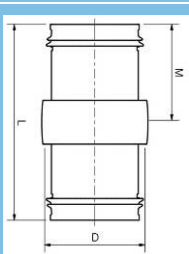

Artikelnr.	Diam. (D)	M	L
HS178141	40	39	79
HS178142	50	41	83

## KOPPELSTUK SMARTLINE CHROOM

Artikelnr.	Diam. (D)	M	L
HS178341	40	39	79

## STEEKMOFFEN SMARTLINE GEBROKEN WIT

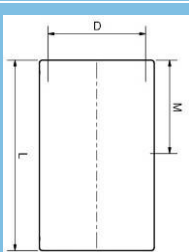

Artikelnr.	Diam. (D)	M	L
HS178100	32	33	67
HS178101	40	39	80
HS178102	50	41	83

## OVERSCHUIFMOFFEN SMARTLINE GEBROKEN WIT

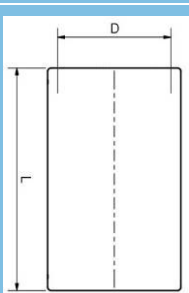

Artikelnr.	Diam. (D)	L
H190522	40	80
H190523	50	83

## T-STUKKEN SMARTLINE 2 X MANCHET / SPIE GEBROKEN WIT

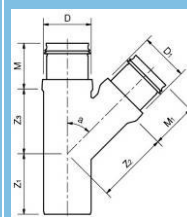

Artikelnr.	Diam. (D/D <sub>1</sub> )	$\alpha$	M	M <sub>1</sub>	Z <sub>3</sub>	Z <sub>1</sub>	Z <sub>2</sub>
HS178051	40 / 40	45°	39	39	55	51	61
HS178052	50 / 40	45°	41	39	60	48	68
HS178053	50 / 50	45°	41	41	67	55	73

## T-STUK SMARTLINE 2 X MANCHET / SPIE CHROOM

Artikelnr.	Diam. (D/D <sub>1</sub> )	$\alpha$	M	M <sub>1</sub>	Z <sub>3</sub>	Z <sub>1</sub>	Z <sub>2</sub>
HS178251	40 / 40	45°	39	39	55	51	61

## T-STUKKEN SMARTLINE GEBROKEN WIT

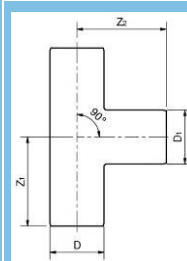

Artikelnr.	Diam. (D/D <sub>1</sub> )	$\alpha$	Z <sub>2</sub>	Z <sub>1</sub>
HS178071	40 / 40	90°	66	66
HS178072	50 / 40	90°	71	68
HS178073	50 / 50	90°	73	73

## T-STUK SMARTLINE CHROOM

Artikelnr.	Diam. (D/D <sub>1</sub> )	$\alpha$	Z <sub>2</sub>	Z <sub>1</sub>
HS178271	40 / 40	90°	66	66

## VERLOOPSTUK SMARTLINE GEBROKEN WIT

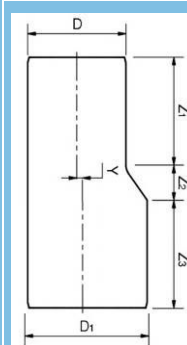

Artikelnr.	uitvoering	Diam. (D <sub>1</sub> /D)	Z <sub>1</sub>	Z <sub>2</sub>	Z <sub>3</sub>	Y
HS178120	spie/spie	40/32	46	5	42	4,0

## VERLOOPSTUK SMARTLINE CHROOM

Artikelnr.	uitvoering	Diam. (D <sub>1</sub> /D)	Z <sub>1</sub>	Z <sub>2</sub>	Z <sub>3</sub>	Y
HS178320	spie/spie	40/32	46	5	42	4,0

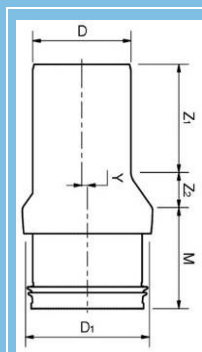
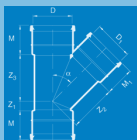

### VERLOOPSTUK SMARTLINE MANCHET/SPIE GEBROKEN WIT

Artikelnr.	uitvoering	Diam (D <sub>1</sub> /D)	Z <sub>1</sub>	Z <sub>2</sub>	M	Y
HS178121	manchet/spie	50/40	46	13	41	2,3

### VERLOOPSTUK SMARTLINE MANCHET/SPIE CHROOM

Artikelnr.	uitvoering	Diam (D <sub>1</sub> /D)	Z <sub>1</sub>	Z <sub>2</sub>	M	Y
HS178321	manchet/spie	50/40	46	13	41	2,3

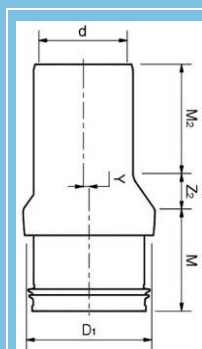

### VERLOOPSTUK SMARTLINE MANCHET/MOF GEBROKEN WIT

Artikelnr.	uitvoering	Diam (D <sub>1</sub> /d)	M <sub>2</sub>	Z <sub>2</sub>	M	Y
HS178127	manchet/mof	40/32	33	6	39	0,0
HS178128	manchet/mof	50/40	33	16	41	2,1

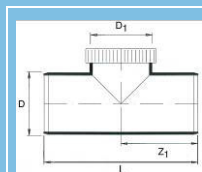

### ONTSTOPPINGSSTUK MET SCHROEFDEKSEL SMARTLINE GEBROKEN WIT

Artikelnr.	Diam. (D/D <sub>1</sub> )	Z <sub>1</sub>	L
HS178181	50/ 50	73	146

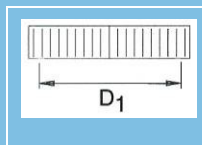

### SCHROEFDEKSEL TBV ONTSTOPPINGSSTUK SMARTLINE GEBROKEN WIT

Artikelnr.	D1
HS178185	50

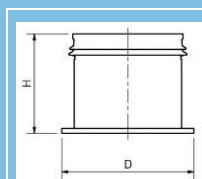

### EINDDOPPEN SMARTLINE MANCHET GEBROKEN WIT

Artikelnr.	Diam. (D)	H
HS178187	40	43
HS178189	50	43

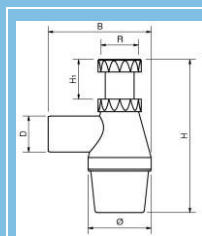

### PLUGBEKER-SIFON SMARTLINE SPIE/DRAAD GEBROKEN WIT

Artikelnr.	Diam. (D)	Ø	H	H <sub>1</sub>	R	B
HS178151	40	70	125	13-95	1 1/4"	114

### PLUGBEKER-SIFON SMARTLINE SPIE/DRAAD CHROOM

Artikelnr.	Diam. (D)	Ø	H	H <sub>1</sub>	R	B
HS178364	40	70	125	13-95	1 1/4"	114

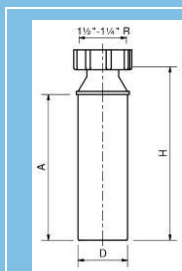

### BOVENSTUKKEN TBV PLUGBEKERSIFON SMARTLINE GEBROKEN WIT

Artikelnr.	Diam. (D)	H	A	Z	d <sub>2</sub>
HS178196	50	148	147		
HS178198	50	148	117	63	20

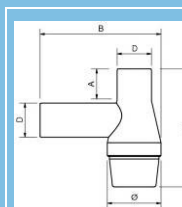
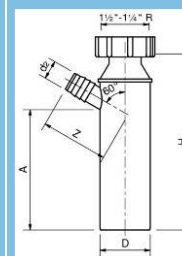

### BEKERSIFON SMARTLINE SPIE/SPIE GEBROKEN WIT

Artikelnr.	Diam. (D)	H	B	Ø	A
HS178152	50	174	176	78	48

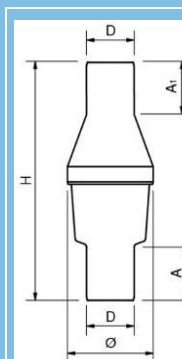

### BEKERSIFON RECHT SMARTLINE SPIE/SPIE GEBROKEN WIT

Artikelnr.	Diam. (D)	H	Ø	A	A <sub>1</sub>
HS178149	40	206	72	47	45

### BEKERSIFON RECHT SMARTLINE SPIE/SPIE CHROOM

Artikelnr.	Diam. (D)	H	Ø	A	A <sub>1</sub>
HS178361	40	206	72	47	45

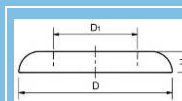

### ROZETTEN SMARTLINE GEBROKEN WIT

Artikelnr.	model	Diam. (D <sub>1</sub> )	H	D
HS178175	hoog	40	30	80
HS178176	laag	40	9	74
HS178177	hoog	50	30	80
HS178178	laag	50	10	80

### ROZET SMARTLINE CHROOM

Artikelnr.	model	Diam. (D <sub>1</sub> )	H	D
HS178351	hoog	40	30	80
HS178355	laag	40	9	74

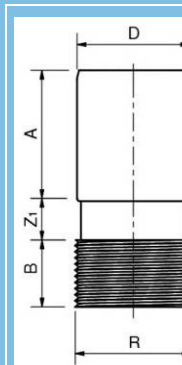

### PLUGGEN SPIE/DRAAD RECHT SMARTLINE GEBROKEN WIT

Artikelnr.	Diam. (D)	R	B	A	Z <sub>1</sub>
HS178171	40	1 1/4"	24	44	14
HS178169	40	1"	20	44	22

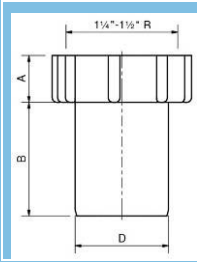
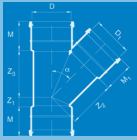

### PLUG SPIE/WARTEL MET DRAAD RECHT SMARTLINE GEBROKEN WIT

Artikelnr.	Diam. (D)	R	B	A
HS178163	40	1/2-1/4"	49	20

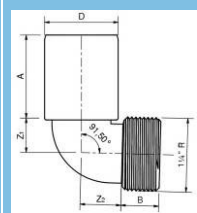

### PLUG SPIE/DRAAD 90° SMARTLINE GEBROKEN WIT

Artikelnr.	Diam. (D)	R	B	A	Z <sub>1</sub>	Z <sub>2</sub>
HS178167	40	1/4"	20	46	19	23

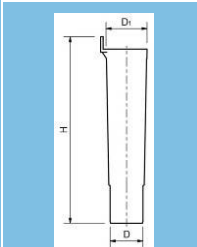

### TRECHTERS SMARTLINE VOOR O.A. WASMACHINE GEBROKEN WIT

Artikelnr.	Diam. (D)	D <sub>1</sub>	H
HS178155	40	45	228
HS178156	50	55	260

### TRECHTER SMARTLINE VOOR O.A. WASMACHINE CHROOM

Artikelnr.	Diam. (D)	D <sub>1</sub>	H
HS178367	40	45	228

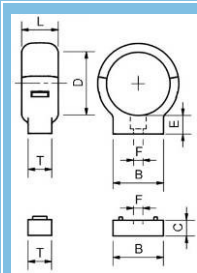

### KLEMBEUGELS SMARTLINE GEBROKEN WIT

Artikelnr.	Diam (D)	L	T	B	C	E	F
HS178131	40	23	15	32	10	12	6
HS178132	50	27	15	32	10	12	6

### KLEMBEUGEL SMARTLINE CHROOM

Artikelnr.	Diam (D)	L	T	B	C	E	F
HS178331	40	23	15	32	10	12	6